

HEAVY DUTY SHADE WITH HOUSING AND CABLES

Installation Instructions

1010

Tools Needed

Drill
3/8" Metal Drill Bit
Screwdriver (Flat & Phillips)
Measuring Tape
Pencil
4" Level
Plumb Line
1/4" Masonry Drill Bit
Hammer
Linesmans Pliers
Cable Cutters

Hardware Provided (per shade)

End Caps (Brackets) (2)
Housing (1)
Shade Fabric Tube (1)
Tie Wire Drives (Cable Anchors) (2)
Hand Brace (1)

Cable Kit

Turnbuckles (2)
Aluminum Lugs with Set Screws (2)
Cables (2 per shade) (2)

Hardware Needed

5/16" X 4 1/2 " Lag Screws or
Appropriate (4 per shade)

3/8" Flat Washers or
Appropriate(4 per shade)



Prepare Back of Housing

Starting at one at end of housing, make two mounting hole marks 1 1/4" in from end cap on your housing.



Using a 3/8" metal drill bit, drill the two mounting holes.

Repeat this process on other side of housing with other end cap.



[Note: Top mount holes are on top of the housing, surface mount holes are on back of the housing.]



Pictures above demonstrate surface mount holes.]



SUN CONTROL
RETRACTABLE SHADES
America's Shade Experts

Toll Free 877-792-1775 | Fax 877-792-0031
swsuncontrolpro.com | sales@swsuncontrol.com

HEAVY DUTY SHADE WITH HOUSING AND CABLES

Installation Instructions

1010

Prepare Back of Housing *(continued)*

[STEPS 1-3]

Start at one end of housing and remove 3 screws attached to housing and set aside.

Repeat same process on other side of housing.

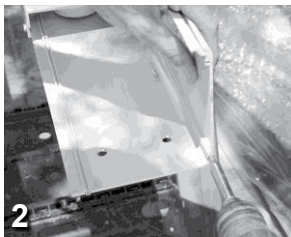
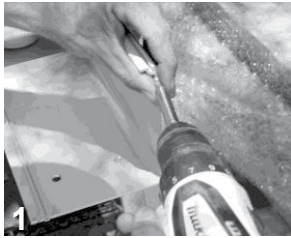

[STEPS 4-6]

Align gear bracket up to screw holes, *(holes you just removed screws from)*

Secure bracket using 3 screws you set aside with Phillips screwdriver.

(Arrows pointing to holes in bracket).

Repeat same process on opposite side with idler bracket.

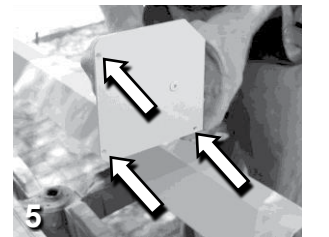
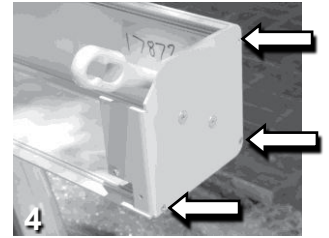

Hang Back of Housing - 2 Person Job

[STEPS 1-3]

Once you decide where your housing will hang, hold back of housing up to surface and starting on one side, drill starter holes into mounting surface and secure first lag screw and washer on top hole.

Make sure your housing is level. Repeat process on other side of housing.



[STEPS 4-5]

Once housing is secure by itself, bolt your final bottom two lags and washers on each side.

Bolts must be installed in upper corner of box—keep away from the center of the box.

Remove hood screws on both sides of housing located underneath the brackets and set aside.



HEAVY DUTY SHADE WITH HOUSING AND CABLES

Installation Instructions

1010



Hang Tube With Fabric - 2 Person Job

Remove bottom rail from pocket of shade fabric.

Remove bolt from cradle idler and place white bearing on pin end.

Starting on gear end, insert square pin end of shade tube into hole in end cap bracket.

On opposite side, slide round pin end of tube into idler end cap slot.

Replace bolt on cradle idler to lock in place.

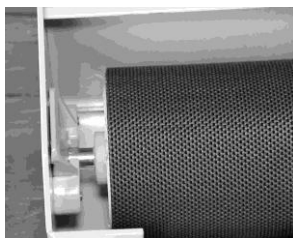
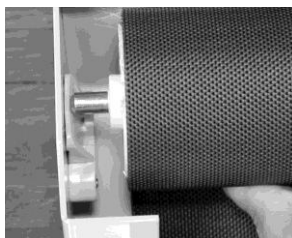
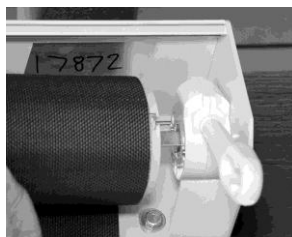

Using provided hand brace, lower shade down slightly and put bottom rail back into pocket of fabric.



Drill Holes For Cable Anchors

Use Plumb Line to hang from hole in housing (where pointing to in picture) down to ground.

Mark spot with pencil for cable anchor.

Drill hole with 1/4" masonry drill bit. Hammer in tie wire drives.

[NOTE: Tie wire drives should be hammered in as far as they can go.]

(You will repeat this process on the other side)



HEAVY DUTY SHADE WITH HOUSING AND CABLES

Installation Instructions

1010

Setting Up & Attaching Cables

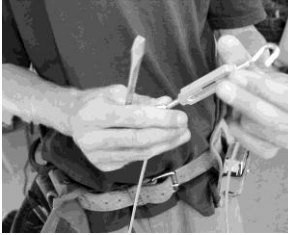

Open turnbuckles by unscrewing each end until $\frac{1}{4}$ " thread remains inside turnbuckle housing.



Attach hook end of turnbuckle to tie wire drive.

At the top of the cable, you will find a small cable clamp that is already attached.

With a flat head screw driver, unscrew front setscrew and remove tension device from cable.



Slip cable up through the eyelet of bottom rail and push up through small hole in bottom of end cap.

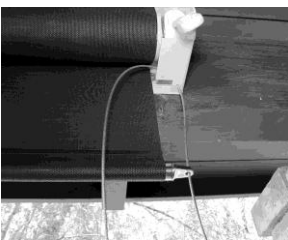

Continue pulling until top of cable is in reach for you to grasp.

Using cable cutters, cut cable to proper length.

Insert cable through clamp and using a flat head screwdriver, tighten down the setscrew.

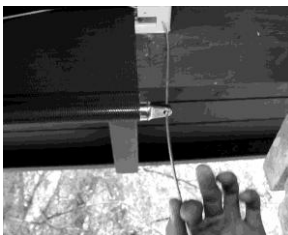

Once clamp is secured, pull cable from just underneath bottom bar eyelet until clamp rests on bottom of housing end cap (as shown).



Close turnbuckles to add tension to cables. (Hold top and turn buckle clockwise).



Repeat whole process on other side.

HEAVY DUTY SHADE WITH HOUSING AND CABLES

Installation Instructions

1010

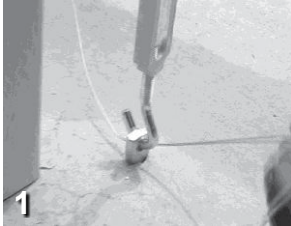

Safety Wire Turnbuckles

Using left over cable, unravel two strands of wire about 10" in length.

Weave strands of wire through tie wire, turnbuckle and then cable loop.

Use pliers to twist wire tight.

Cut off excess.

This prevents the turnbuckle from twisting and loosening the cables.

You will repeat this on the other side.

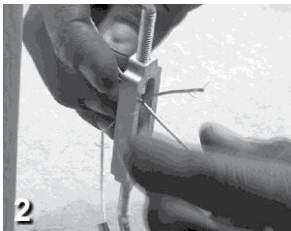

Install Front/Bottom Housing

Before securing front housing, first rotate gear to lie vertical

Install the two hood screws you put aside earlier, one on each side.

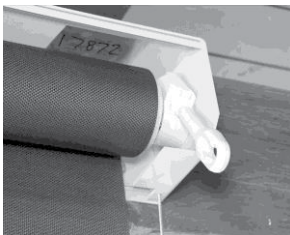

Set the housing into the groove at the top and bring down to set into place.



Your set up should now be complete and look like this.

HEAVY DUTY SHADE WITH HOUSING AND CABLES

Installation Instructions

1010



Operate Shade

Slide hook end of hand brace into eyelet of gear on shade.

Rotate hand brace in one direction to raise.

Rotate in opposite direction to lower.

Shade rolls up and down on cable guides.

